

Search ArchDaily

ArchDaily > Plays > Community Center > Cambodia > Cambodia Agricultural Technology Center / Squire & Partners

Cambodia Agricultural Technology Center / Squire & Partners + SAWA



Save this project



Curated by Paula Pintos

COMMUNITY CENTER · KRONG SAMRAONG, CAMBODIA

- Architects: **SAWA**, **Squire & Partners**
- Area: **310 m²**
- Year: **2018**
- Suppliers: ISI Cambodia, Viglacera, fabricated on site from stabilized earth or rice husks, locally made woven bamboo screens, locally produced cassava and sand plaster, woven grass mats created by local women's cooperative

- Structural And Sustainable Engineering: Buro Happold / Happold Foundation
- Architectural Design and Support: Building Trust International
- Structure And Roof Contractor: Tat Sovattana Architecture Ltd
- Construction, Permaculture And Natural Plaster: OrganikH Farm
- Water Contractor And Sanitation Specialist: Cambodian Health & Human Rights Alliance
- Local Partner And Managers: Community Integrated Development Organization Cambodia
- Client: Green Shoots Foundation

LESS INFORMATION



salesforce

ROAD TO RESILIENCE

Farfetch look to the 'new normal'.

LEARN MORE

LEADING THROUGH CHANGE

MORE COMMUNITY CENTER

- Jaklitsch / Gardner Architects Design Beekeeping and Honey Extraction Center in Tanzania
- Montmatre / Babin + Renaud multi-use
- First Place in the Nuevo Gramalote Peasant House Competition / Colombia

[More Community Center >](#)

MOST VISITED

- Hemp concrete: From Roman bridges to a possible material of the future
- Basic guide: How to choose a kitchen or bathroom faucet?
- Houses with side patios: Natural light and ventilation through narrow gardens

MOST VIEWED PRODUCTS

- Glazed Grill for Quinchos | Ducasse Industrial



LOOP and LOOPXL Anchor Points | Rothoblaas



Exterior Wood Finishing and Protection | Nuprotec

Recommended Products

LATTICES / SHUTTERS



Ducasse Industrial
Sliding System for Mobile Facades / Parasols / Solar Control

ADHESIVES



Nuprotec
Akfix Polyurethane Foam Adhesive for Concrete, Stone and Brick

Search: exterior_burdett_road — No Results

You can search for that file (again!) ... or you could use OpenAsset

[LEARN MORE](#)

Description sent by the project team. A new community center for Agriculture and Technology has been launched in **Krong Samraong**, Cambodia. Designed as a collaboration between Squire & Partners and SAWA for the Green Shoots Foundation, the project was built by local contractors, farmers and youth aged 16-25 over a period of four months, and was assisted by volunteers from the UK. The project provides education in agricultural technologies to support children and adults in the local community, in addition to seeking facilities that attract companies to the region.



The elements within the planning were designed to respond to the tropical climate, with raised floors to control the risk of floods, screens to diffuse sunlight and provide ventilation, and eaves specially designed for the rainy season. The project was carried out with the use of local resources, work and skills in mind.



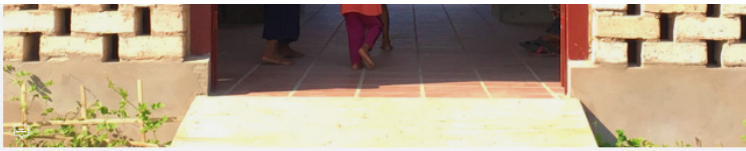

The main structure provides a multipurpose room with office and storage spaces, and a spacious balcony. From the sturdy steel frame, the sealing materials include site-made bricks, rice husk blocks, and clay and bamboo screens. Cassava and sand plaster is used to make some walls, created in collaboration with the local organic farm OrganiKH.

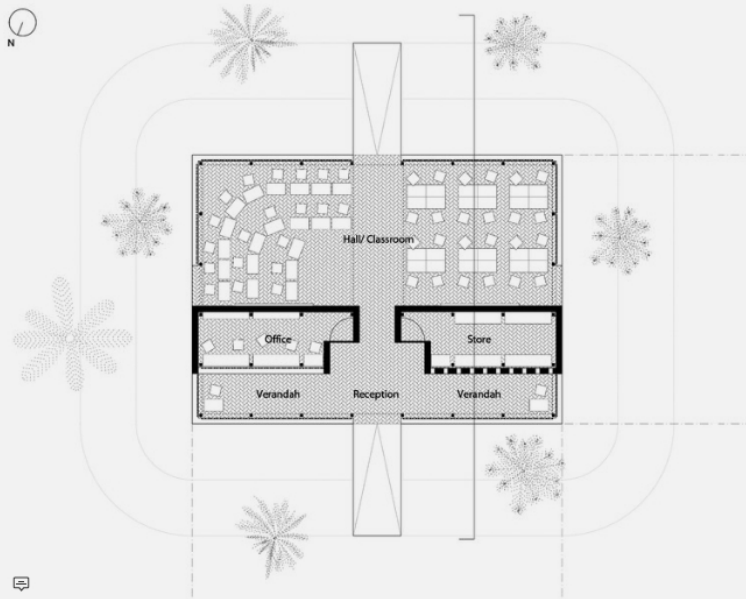



Internally, a bamboo-shaped entrance ramp leads to a flexible space on the covered terrace with built-in benches used both for workshops and pop-up shops for local producers. The office and storage uses make the separation between the social terrace and the two generous classrooms located on each side of the central corridor.



A panel made of fabric woven by a local women's cooperative, can be lowered to divide the space in two, making two half-size rooms, or can also be rolled up to create a large meeting space. This type of loom is also used as blinds and roof covers, while local bamboo fishermen's baskets have been adapted as lamps.



Las habitaciones más pequeñas brindan refugio para un lugar donde fabricar bloques, un baño de biogás con un techo de bambú en espiral cubierto por una estructura metálica reutilizada, un gallinero, un sistema para capturar y filtrar agua, y un tipo de huerto hecho de un túnel de bambú que da paso a plantas nativas como pepinos y frijoles. Letreros pintados a mano en Khmer e inglés identifican cada edificio dentro del sitio.





The Agriculture and Technology Center was opened by the Mayor of [Krong Samraong](#) and Governor HW Lim Sokto on December 20, 2018. This first phase provided a series of buildings that will serve up to 200 students by 2020, with a second phase planned for expand teaching facilities and create a solar supply to support development.



The project was funded through an innovative model of 'vacation packages' for volunteers, crowdfunding, Khmer Supper Clubs promoted by Squire & Partners, and awareness raising with a conceptual development model that was exhibited at the Royal Academy Summer Exhibition in London in the summer of 2018. Learn more [here](#).



Project Gallery





Location of the work

Address: Krong Samraong, Cambodia



Location to be used for reference only. It could indicate city / country, but the address is not exact.

About this office

Squire & Partners

Office

FOLLOW

SAWA

Office

FOLLOW

MATERIALITY

Wood

Brick

#TAGS

Plays

Built Projects

Outstanding Works

Public Buildings

Community

Community Center

Krong Samraong

Cambodia

Posted on August 04, 2020

Citation: "Cambodia Agricultural Technology Center / Squire & Partners + SAWA" [Agriculture Technology Center, Cambodia / Squire & Partners + SAWA] 04 Aug 2020. Architecture Platform . Accessed Aug 4, 2020 . <https://www.plataformaarquitectura.cl/cl/945027/centro-de-tecnologia-agricola-de-camboya-squire-and-partners-plus-sawa> ISSN 0719-8914

EXPLORE THE CATALOG

STONES



Rothoblaas
Monolithic
Breathable Sheet -

PRECAST SYSTEMS / ...



Rothoblaas
Variable diffusion
sheet - CLIMA

ADHESIVES



Rothoblaas
Universal
mono adhesive tap

SURFACE PROTECTORS

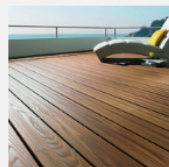

Nuprotec
Deck Oil - Osmo
Decking Oil