



# Working with friends

The way we work is continuously evolving so why shouldn't our environment too? Hot desking, office sharing and staying connected while travelling are common modern-day needs. There are advantages to embracing co-working

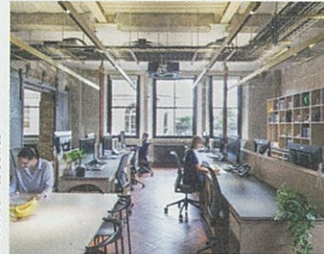
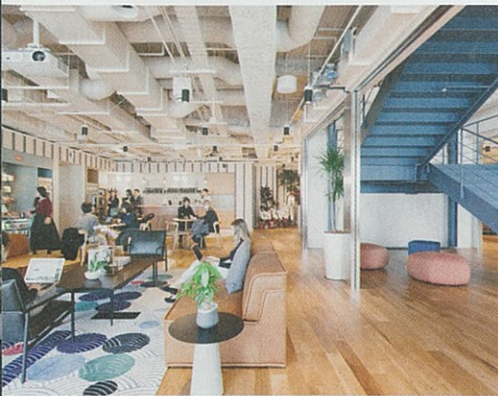

Photo: James Jones

"WE'RE LOOKING AT HOW TO INNOVATE IN THE WORKPLACE"

WeWork creative spaces can be found all over the world. The Department Store in Brixton (top right) has been developed by architects Squire & Partners



Something of a renaissance is happening in the way we approach going to work. A new wave of freelancers and start-up businesses has created a demand for flexible workplaces where people can come together and work side by side in a collaborative environment. This phenomenon is growing at such a pace that global innovators WeWork (who have a chain of over 70 such offices in 24 countries) is now one of the fastest growing businesses in the world. Combining our much-loved café culture with the exclusivity of member's clubs, these friendly and lively co-working spaces offer more than just a desk and a Wi-Fi connection. In London, for example, there's The Department Store in Brixton, Forge & Co in Shoreditch and Makerversity at Somerset House, as well as multiple WeWork destinations. WeWork regional design director for Europe and India, Andy Heath, told us how WeWork are bringing people and ideas together: "We use technology to understand how the space is used, in order to be able to optimise it. For example, we noticed people would frequently stop and chat on the stairs, so we now incorporate additional wide, internal staircases in our buildings to encourage this connectivity." WeWork's UK GM, Leni Zneimer adds: "We actually don't consider ourselves a co-working space. We host events in our spaces (ranging from business talks, to yoga or boxing) and connect our members, so we really think of ourselves as a community. We're working on incorporating AI technology into our sites too, so that you can programme your preferred desk height into your keycard, and any desk you work from will recognise this and revert to your preferences. This is just one of the ways we are looking at how to innovate in the workplace in the interests of its users." *enki* will be following this progress with interest.

To find more international co-working spaces log onto [enkimagazine.com](http://enkimagazine.com)



WeWork co-founder Miguel Mckelvey

